

LTO External Standalone Tape Drive

Important LTO-9 Information Below

This document describes how to setup and install an external LTO standalone tape drive from Overland-Tandberg.

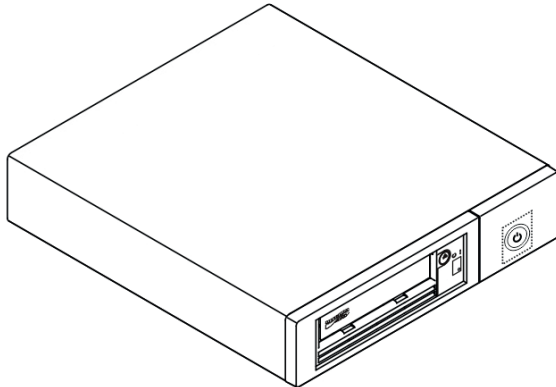

CAUTION:

While working with the unit, observe standard Electrostatic Discharge (ESD) precautions to prevent damage to micro-circuitry or static-sensitive devices.

NOTE: Before continuing, verify you are able to connect to the host SAS controller via an installed host bus adapter (HBA) and have the correct cable (available separately) to attach the tape drive to it.

Step 1

Register the Unit

It is **essential** that you activate your warranty before proceeding as technical and warranty support is **not available** until your product is registered.

1. Go to the Overland-Tandberg support page: <https://www.overlandtandberg.com/service-support/customer-self-service-portal/>
2. Select the Register a Product option.
3. Fill in the information (including the serial number) and click **Submit**.
Your warranty certificate will be emailed to you. Follow the email instructions to complete the process.

Step 2

Connect Your Drive

To connect your new Overland-Tandberg LTO External tape drive to your computer, follow these steps:

1. Plug your SAS cable (1) into the external tape drive and the other end into the server.

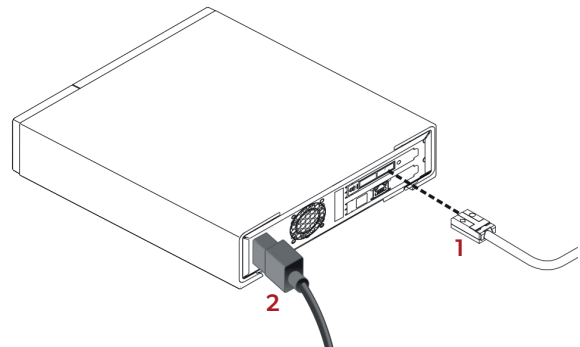

2. If connecting a second host computer, plug in a second SAS cable (2) into the tape drive and the other end into the HBA on your second computer.
3. Connect the power cord (3) to the tape drive.

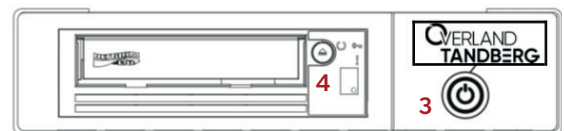

4. To eject the media, press the eject button (4).

Step 3

Verify Firmware & Drivers

Check online for the latest versions of the LTO firmware and drivers for the Overland-Tandberg LTO External Tape Drive:

https://ftp.overlandtandberg.com/Firmware/Tape_Drives/

If needed, the tape drive diagnostic tool with instructions is also available at the same site.

We also recommend upgrading your backup software application to ensure it works correctly with your tape drive.

Step 4

Ordering Media

Overland-Tandberg LTO external tape drives utilize Ultrium LTO data cartridges, as well as LTO cleaning cartridges. Used in the design, test, and manufacture of your drive, Overland-Tandberg LTO media provides superior data availability.

Contact your Overland-Tandberg sales representative to place your order for the desired media types and quantities.

For the most current information, refer to the Overland-Tandberg price list.

For detailed information on media care and best practice and to order online, refer to the Overland-Tandberg Media website:

<https://www.overlandtandberg.com/products/neo-tape/lto-media/>

Step 5

Further Information

For further information regarding your product, check out the following links.

User Guides

An electronic version of this Quick Start Guide along with additional information is also available online at our Knowledge Base:

<https://www.overlandtandberg.com/knowledgebase>

Warranty/Technical Support

For warranty and general technical support information, see our Contact Us web page:

<https://www.overlandtandberg.com/contact-us/>

For information on contacting Overland-Tandberg Service and Support:

<https://www.overlandtandberg.com/service-support/contact-service-support>

Initializing LTO-9 Tapes

New LTO-9 cartridges need to be initialized before they can be used because the increased number of tracks requires greater precision. Media optimization creates a referenced calibration for each cartridge that enables the tape drive's intelligent alignment to optimize data placement. LTO-9 media optimization enhances LTO tape long-term media durability.

Media optimization is performed on first load of LTO-9 media during initialization.

Media optimization is a one-time operation that can be completed on any drive in the environment, enabling the media to be used across all tape drives without further optimization.

During cartridge initialization, the Single Character display will show a lowercase "c" (calibrating).

Media optimization averages 40 minutes per first load of a cartridge to a tape drive.



CAUTION:

Although most media optimizations will complete within 60 minutes, some media optimizations may take up to 2 hours. Interruption of the process is not recommended.