

# Power Supply Module Instructions

This document describes how to either add a redundant Power Supply Module or replace an existing Power Supply Module in an RDX QuikStation 8 from Overland-Tandberg.

**CAUTION:** While working with the appliance, observe standard Electrostatic Discharge (ESD) precautions to prevent damage to micro-circuitry or static-sensitive devices.



Version 3 Power Supply Module

## Update the System

**IMPORTANT:** Before starting, make sure that the QuikStation 8 has been updated to firmware version 2.8 or later.

1. Download and install firmware version 2.8 or later.  
<https://ftp1.overlandtandberg.com/rdx/RDX%20QuikStation/Firmware/>
2. To verify the update, from the QuikStation 8 Remote Management Interface main menu, select **Help > About**.

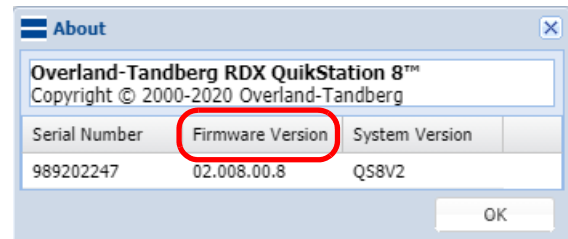

## Determine System Version

**IMPORTANT:** Each version of QuikStation 8 has a unique Power Supply Module only works with that version. (See the table to the right.) You must have the correct Power Supply Module for your QuikStation 8 before continuing.

1. To check your version, from the QuikStation 8 Remote Management Interface main menu, select **Help > About**.
2. Make a note of the **System Version** shown.
3. Proceed to the **appropriate section** for your needs:
  - **Add A Redundant Module** – To add a redundant power supply to a single-module system.
  - **Replace A Non-redundant Module** – To replace a power supply in a single-module (non-redundant) system.
  - **Replace A Redundant Module** – To replace a power supply in a dual-module (redundant) system.

QuikStation 8 Version	Power Supply Module
Version 1	8991-RDX
Version 2	8993-RDX
Version 3	8995-RDX

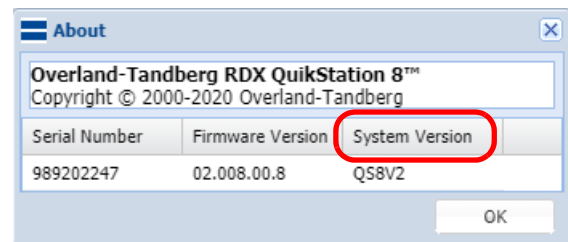

### Determining Version of a Non-functioning Unit

If it is not possible to power on the QuikStation, you can still determine the unit's version based on the rear panel.

- **Version 1** models (both 8930-RDX and 8940-RDX) have a set of extra vent holes above the rear ports and an Ethernet interface card in the far right slot. The 8940-RDX model also has a 10GbE card in the slot next to it.
- **Version 2** model has fewer ports and does not have the additional vent holes or any interface cards found on Version 1.
- **Version 3** model is similar to Version 2 but the Power Supply Module handle lays downward instead of sideways. If there is only one Power Supply Module, the top bay has a cover with screws.

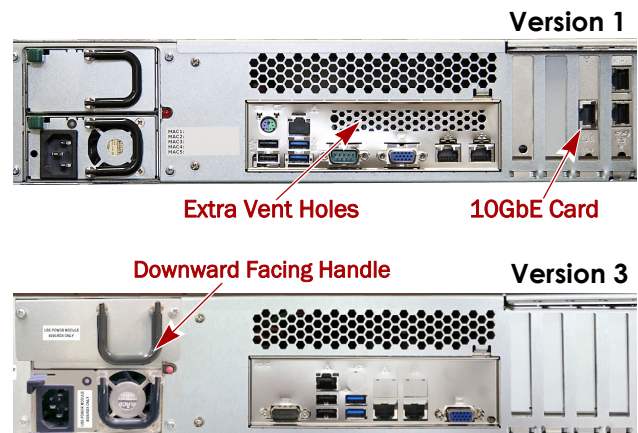

## Add A Redundant Module

### Version 1 or 2 Module Add-on

**NOTE:** A redundant Power Supply Module can be added to a single-module QuikStation 8 without shutting it down.

1. Identify the **blank module**.  
It does not have an active AC power socket.
2. Push the module **lock lever** to the right and, at the same time, pull the **handle**.  
Set the blank module aside.
3. With latch lever positioned to the left, slide the **new module** into the bay until the latch locks.

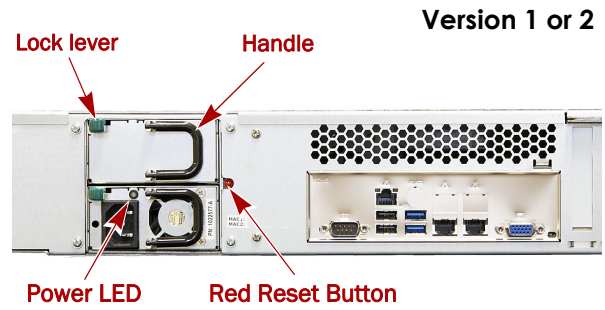

### Version 3 Module Add-on

**NOTE:** A redundant Power Supply Module can be added to a single-module QuikStation 8 without shutting it down.

1. Remove and retain the **two cover screws** holding on the empty module bay cover.
2. After removing and setting aside the **cover**, reinstall the **two screws** to secure the receiver bay.
3. With latch lever positioned to the left, slide the **new module** into the bay until the latch locks.

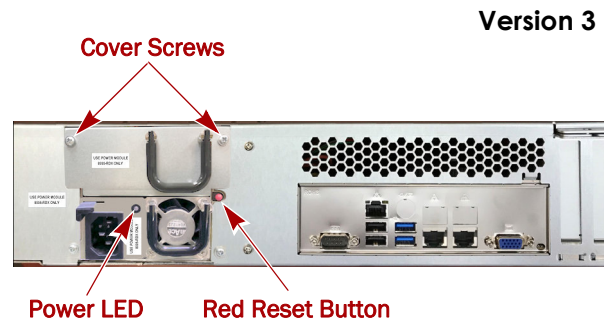

### Power On The Power Supply Module

Once the redundant Power Supply Module is installed, attach a **power cord** to it to power it on.

Because the RDX QuikStation 8 remained running during the installation, it will recognize the new module automatically. The LEDs on both Power Supply Modules should be green.

**NOTE:** If the PSU alarm sounds at any time, mute it by pressing the red reset button on the right of the Power Supply Unit.

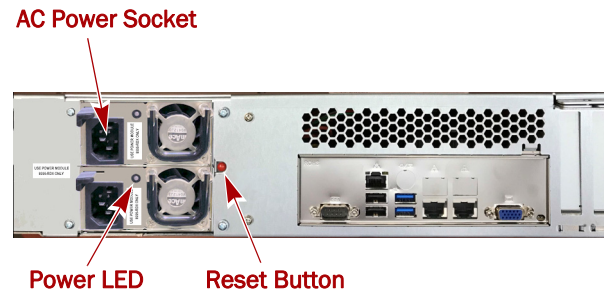

## Replace A Non-redundant Module

### Power Off The QuikStation 8

**CAUTION:** To prevent data loss, verify that all processes are complete before powering off the system.

1. At the front, press and release the **Power** button.  
Wait for all the LEDs to go off.
2. At rear of the unit, remove the **power cable** from the Power Supply Module.

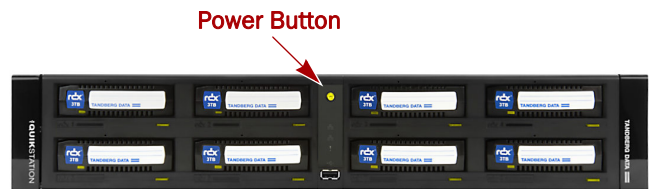

## Single-Module Replacement

Use this procedure for all QuikStation 8 versions.

1. Push the module **latch** lever to the right and, at the same time, pull the **handle**.  
Set the old module aside.
2. With latch lever positioned to the left, slide the **replacement module** into the bay until the latch locks.
3. Put the **old module** in the same shipping carton that the new module came in and return it Overland-Tandberg using the RMA instructions that came with the part.

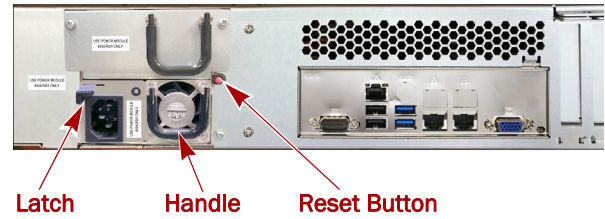

## Power On The QuikStation 8

1. Attach the **power cord** to the new Power Supply Module.
2. Press and release the **Power button** on the front panel to power on the unit.

The RDX QuikStation 8 will automatically recognize the new module when powering up. The LED on the Power Supply Module should be green.

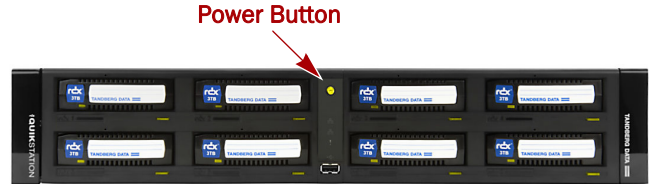

**NOTE:** If the PSU alarm sounds at any time, mute it by pressing the red Reset Button on the right of the Power Supply Unit.

# Replace A Redundant Module

## Redundant Module Replacement

**NOTE:** A Power Supply Module can be replaced in a dual-module (redundant) QuikStation 8 without shutting it down.

Use this procedure for all QuikStation 8 versions.

1. Identify the **failed module** with the amber Power LED.
2. On the failed module, push the **latch lever** to the right and, at the same time, pull the **handle**.  
Set the failed module aside.
3. With latch lever positioned to the left, slide the **replacement module** into the bay until the latch locks.
4. Attach its **power cord** to power the module on.  
Because the RDX QuikStation 8 remained running during the installation, it will recognize the new module automatically.

The LEDs on both Power Supply Modules should be green.

**NOTE:** If the PSU alarm sounds at any time, mute it by pressing the red reset button on the right of the Power Supply Unit.

5. Put the **old module** in the same shipping carton that the new module came in and return it Overland-Tandberg using the RMA instructions that came with the part.

Version 1 or 2

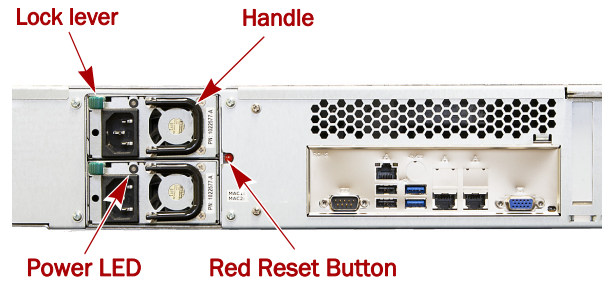

Version 3

